

Product Usage Guide

Professional



Health Hazard



Serious Health Hazard



Corrosive

BB092-25



Health & Safety

Please refer to relevant COSHH Safety Data Sheet



Scan for further product details

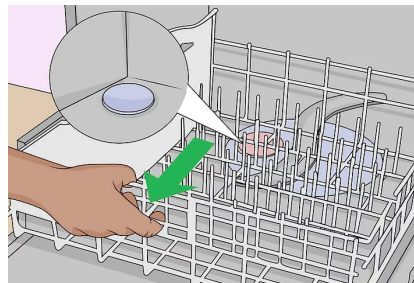

- 1** Remove the bottom rack to expose the salt reservoir.

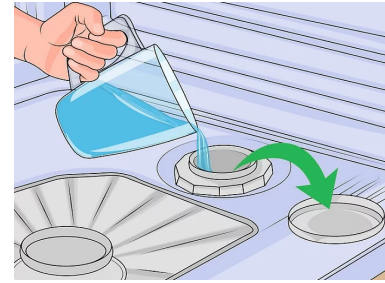

- 2** If a new machine, check for water and fill reservoir if empty.



- 3** Use Water Softener Salt Granules in your dishwasher.



- 4** Pour salt into the funnel until the reservoir is full.



- 5** Clean any excess salt with a wet cloth.

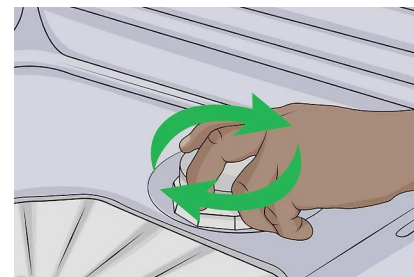

- 6** Screw the cap on tightly.

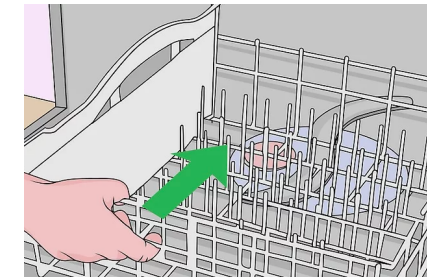

- 7** Replace the bottom rack and run the dishwasher normally.